

PANTIN

PANTIN CLICK

Foot ascender
Bloqueur de pied

**NOT PPE
NON EPI**



7 <math>\leq \varnothing < 13 \text{ mm}</math>

WARNING / ATTENTION

Activities involving the use of this equipment are inherently dangerous. You are responsible for your own actions and decisions.

Before using this equipment, you must:

- Read and understand all Instructions for Use.
- Get specific training in its proper use.
- Become acquainted with its capabilities and limitations.
- Understand and accept the risks involved.



FAILURE TO HEED ANY OF THESE WARNINGS MAY RESULT IN SEVERE INJURY OR DEATH.

Les activités impliquant l'utilisation de cet équipement sont par nature dangereuses. Vous êtes responsable de vos actes, de vos décisions et de votre sécurité.

Avant d'utiliser cet équipement, vous devez :

- Lire et comprendre toutes les instructions d'utilisation.
- Vous former spécifiquement à l'utilisation de cet équipement.
- Vous familiariser avec votre équipement, apprendre à connaître ses performances et ses limites.
- Comprendre et accepter les risques induits.



LE NON-RESPECT D'UN SEUL DE CES AVERTISSEMENTS PEUT ÊTRE LA CAUSE DE BLESSURES GRAVES OU MORTELLES.

PETZL.COM



Latest version
Dernière version



Other languages
Autres langues



Technical tips
Conseils techniques



PPE inspection
Vérification EPI

Warning symbols
Panneaux d'alertes



PETZL
FR-38920 Crolles
Cdex 105A
PETZL.COM
ISO 9001
© 2025 Petzl
Distribution



Sustaining our Community
Au service de la Communauté
FONDATION-PETZL.ORG



PANTIN

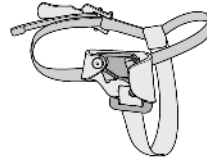

PANTIN CLICK

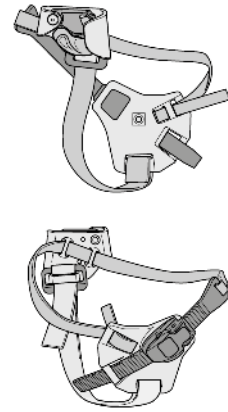

1. Field of application (text part) Champ d'application (partie texte)



Example
Exemple



Maxi. 150 kg

2. Inspection, points to verify (text part) Contrôle, points à vérifier (partie texte)

3. Compatibility Compatibilité

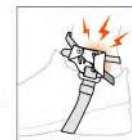

4. Installation

1.



LEFT (Black) RIGHT (Yellow)
GAUCHE (Noir) DROIT (Jaune)



2.



3.

PANTIN

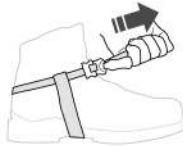

PANTIN CLICK



CLIC-CLIC...



CLIC-CLIC-CLIC-CLIC...



5. Installing the rope
Mise en place de la corde

Rope insertion
Insertion de la corde

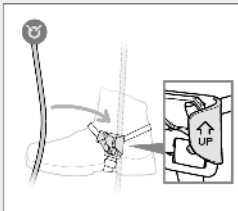

Without catch
Sans taquet



With catch
Avec taquet

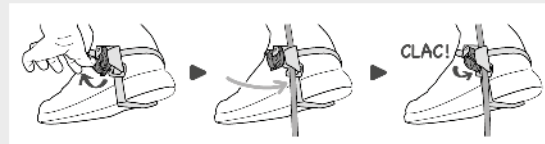

Rope release
Dégagement de la corde

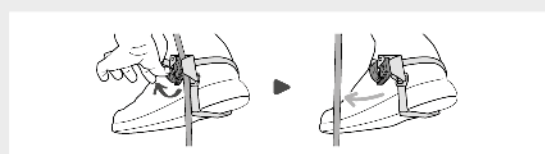
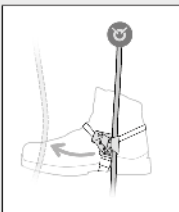

6. Progression on rope
Progression sur corde

Simultaneous progression
Progression en simultané

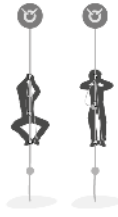

Alternating progression
Progression en alternatif



7. Additional information
Informations complémentaires

A. Lifetime /
Durée de vie



unlimited
illimitée

B. Acceptable T° / T° tolérées

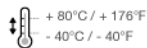

+ 80°C / + 176°F
- 40°C / - 40°F

C. Precautions for use / Précautions d'usage



etc...

D. Cleaning / Nettoyage



+ 30°C maxi.
+ 86°F maxi.

E. Drying / Séchage



+ 30°C maxi.
+ 86°F maxi.

F. Storage - Transport / Stockage - transport



G. Maintenance / Entretien



H. Modifications - Repairs
Modifications - Réparations



→ Petzl

I. FAQ - Contact
Questions - Contact



→ petzl.com

Precautions for use
Précautions d'utilisation

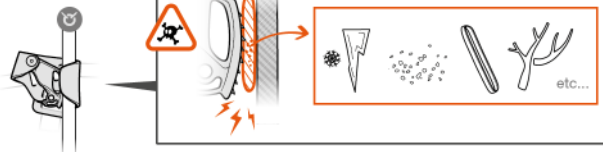

PANTIN strap (right or left)
Sangle PANTIN (droit ou gauche)

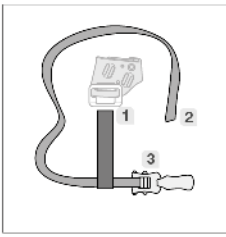

PANTIN CLICK strap (right or left)
Sangle PANTIN CLICK (droit ou gauche)

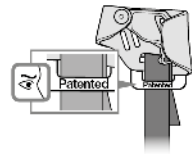
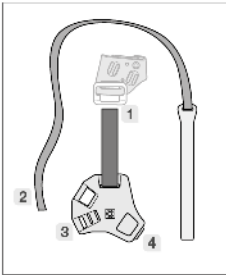

Catch for PANTIN (right or left)
Taquet pour PANTIN (droit ou gauche)

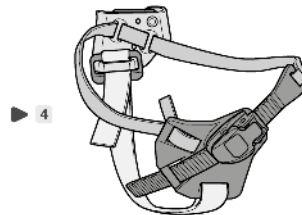
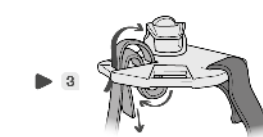
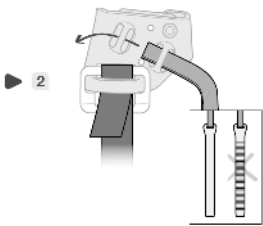
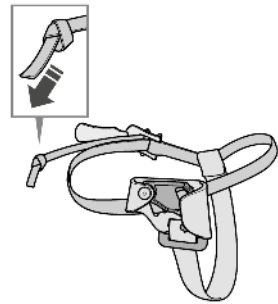
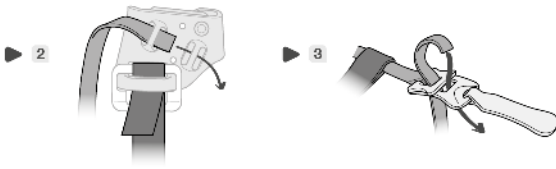
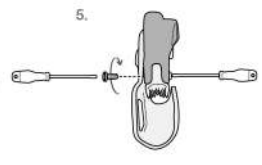
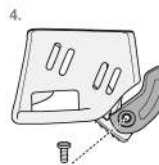
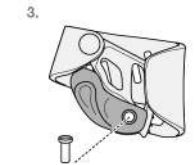
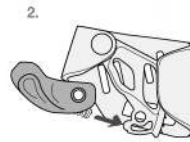

Compatibility / Compatibilité

| | PANTIN < 2026 | PANTIN > 2026 | PANTIN CLICK |
|---------------------|------------------|------------------|-----------------|
| Sangle PANTIN | ✓ | ✓ | ✓ |
| Sangle PANTIN CLICK | ✓ | ✓ | ✓ |
| Taquet pour PANTIN | ✓ | ✓ | ✗ |